

INFO-SHEET

Steel Sheet Pile

SEPT. 11



ArcelorMittal

GU 16N

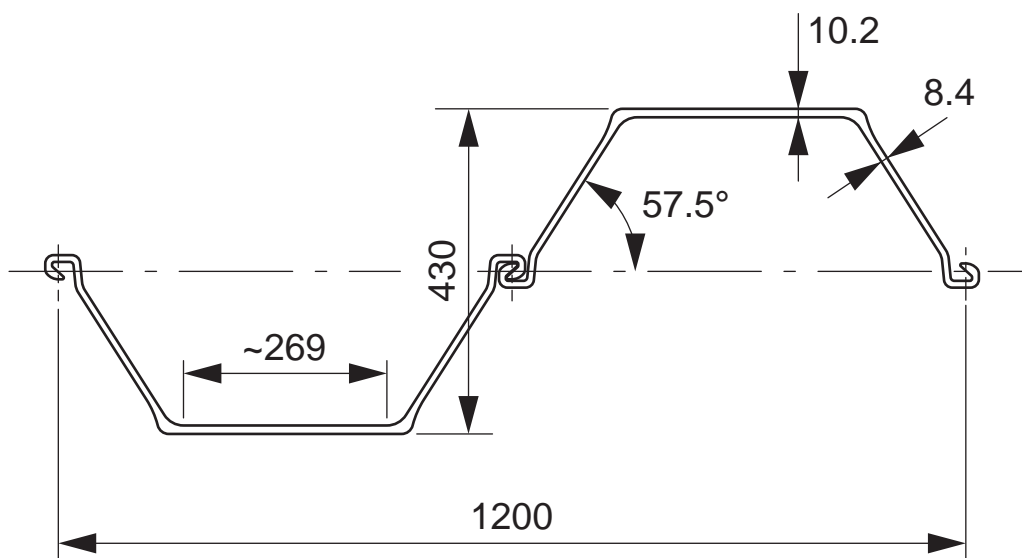

scale: 1/10

	Sectional area	Mass	Moment of inertia	Elastic section modulus	Plastic section modulus	Static moment	Radius of gyration	Coating area *
	cm ²	kg / m	cm ⁴	cm ³	cm ³	cm ³	cm	m ² / m
Single Pile	92.5	72.6	6 960	473			8.67	0.87
Double Pile	185.0	145.2	43 140	2 005			15.30	1.72
Triple Pile	277.5	217.8	59 840	2 330			14.69	2.58
Per m of wall	154.2	121.0	35 950	1 670	1 988	980	15.30	1.43

ArcelorMittal reserves the right to change the section properties without prior notice

* 1 side, excluding inside of interlocks

ArcelorMittal Commercial RPS S.à r.l.
 Sheet Piling
 66, rue de Luxembourg
 L-4221 Esch sur Alzette | Luxembourg

T +352 5313 3105
 F +352 5313 3290
www.arcelormittal.com/sheetpiling
sheetpiling@arcelormittal.com

05.09.2011

FICHE D'INFORMATION

Palplanche

SEPT. 11



ArcelorMittal

GU 16N

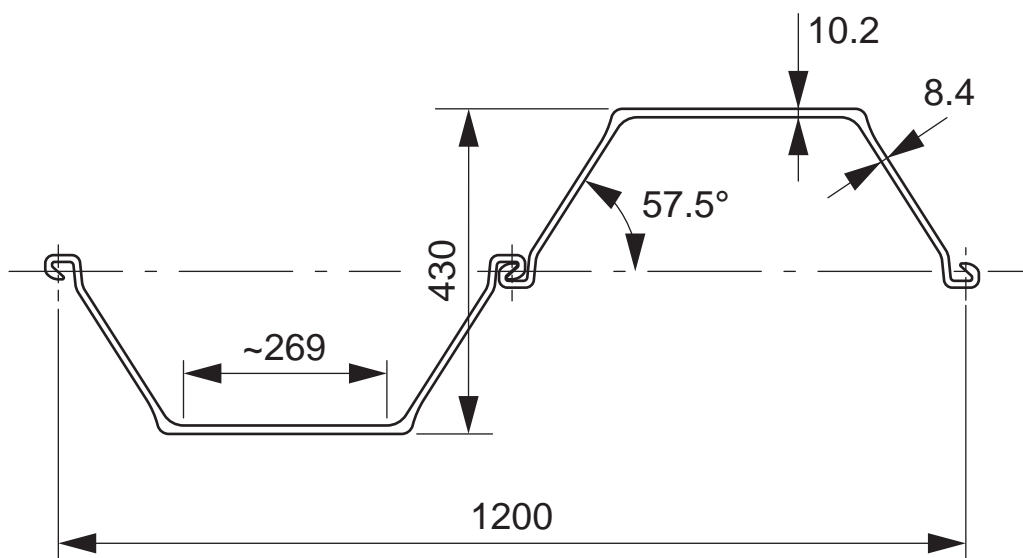

échelle: 1/10

	Section d'acier cm ²	Masse kg / m	Moment d'inertie cm ⁴	Module de flexion élastique cm ³	Module de flexion plastique cm ³	Moment statique cm ³	Rayon de giration cm	Surface à traiter * m ² / m
Palpl. simple	92.5	72.6	6 960	473			8.67	0.87
Palpl. double	185.0	145.2	43 140	2 005			15.30	1.72
Palpl. triple	277.5	217.8	59 840	2 330			14.69	2.58
Par ml de rideau	154.2	121.0	35 950	1 670	1 988	980	15.30	1.43

ArcelorMittal se réserve le droit de modifier les caractéristiques de ses profils sans préavis

* 1 côté, intérieur des serrures exclu

ArcelorMittal Commercial RPS S.à r.l.
 Palplanches
 66, rue de Luxembourg
 L-4221 Esch sur Alzette | Luxembourg

T +352 5313 3105
 F +352 5313 3290
www.arcelormittal.com/palplanches
palplanches@arcelormittal.com

05.09.2011

PROFILDATENBLATT

Spundwand

SEPT. 11



ArcelorMittal

GU 16N

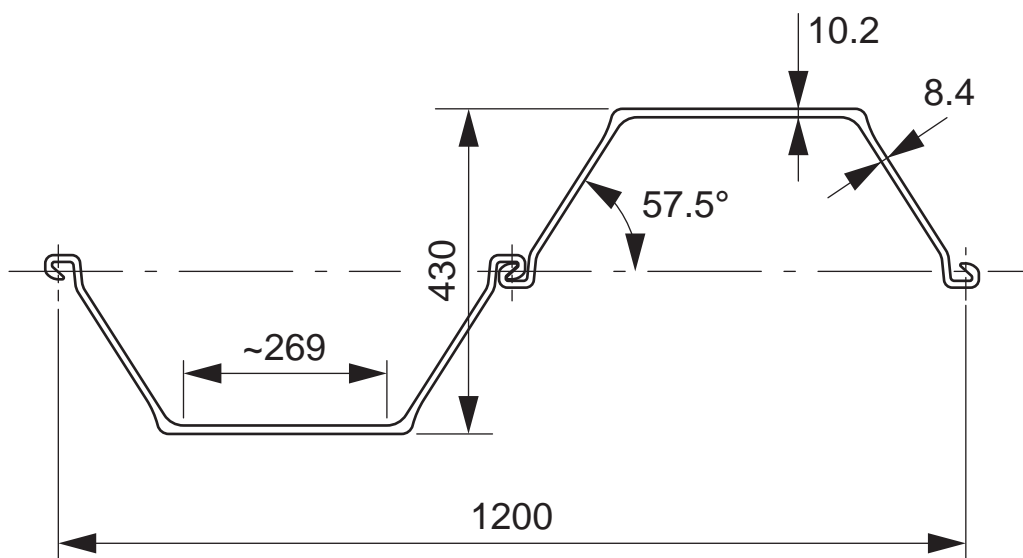

Masstab: 1/10

	Querschnittsfläche	Eigenlast	Trägheitsmoment	Elastisches Widerstandsmoment	Plastisches Widerstandsmoment	Statisches Moment	Trägheitshalbmesser	Anstrichfläche *
	cm ²	kg / m	cm ⁴	cm ³	cm ³	cm ³	cm	m ² / m
Einzelbohle	92.5	72.6	6 960	473			8.67	0.87
Doppelbohle	185.0	145.2	43 140	2 005			15.30	1.72
Dreifachbohle	277.5	217.8	59 840	2 330			14.69	2.58
Je m Wand	154.2	121.0	35 950	1 670	1 988	980	15.30	1.43

ArcelorMittal behält sich das Recht vor, die geometrischen Profileigenschaften ohne vorherige Ankündigung zu ändern

* 1 Seite, ohne Schlossinneres

INFO-SHEET

Steel Sheet Pile

SEPT. 11



ArcelorMittal

GU 16N

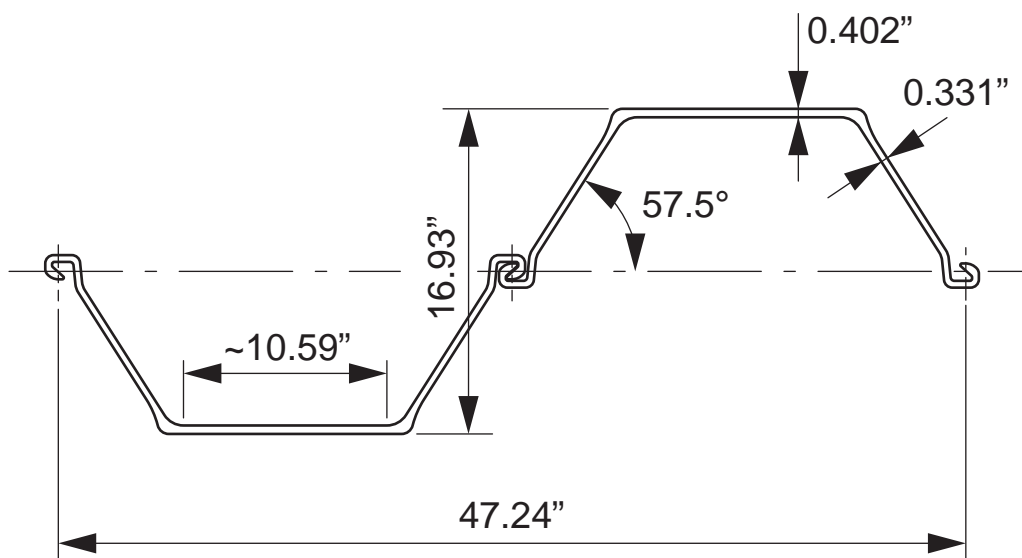

scale: 1/10

	Sectional area in ²	Mass lb / ft	Moment of inertia in ⁴	Elastic section modulus in ³	Plastic section modulus in ³	Static moment in ³	Radius of gyration in	Coating area * ft ² / ft
Single Pile	14.34	48.78	167.2	28.9			3.41	2.85
Double Pile	28.68	97.57	1 036.4	122.4			6.02	5.64
Triple Pile	43.01	146.35	1 437.7	142.2			5.78	8.46
Per ft of wall	7.29	24.78	263.3	31.1	37.0	18.2	6.02	1.43

ArcelorMittal reserves the right to change the section properties without prior notice

* 1 side, excluding inside of interlocks

ArcelorMittal Commercial RPS S.à r.l.
 Sheet Piling
 66, rue de Luxembourg
 L-4221 Esch sur Alzette | Luxembourg

T +352 5313 3105
 F +352 5313 3290
www.arcelormittal.com/sheetpiling
sheetpiling@arcelormittal.com

05.09.2011